

BENCHMARK:
CONTROL POINT F5136 LOCATED AT
NORTH EAST CORNER #2031 ROBB AVENUE
ELEV. = 50.162

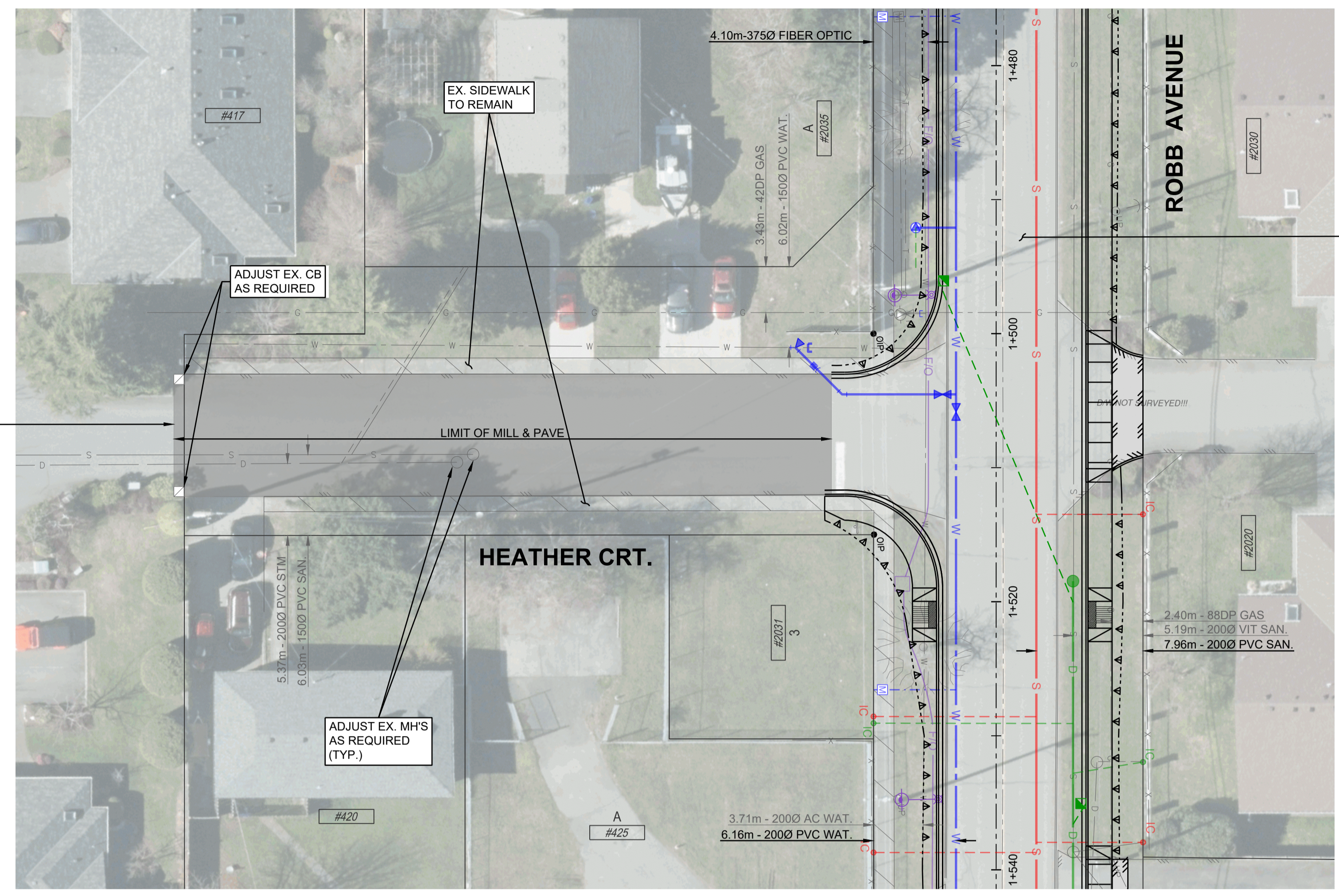

SAW CUT ALONG EX. ASPHALT INSTALL TRANSVERSE JOINT. EXACT LOCATION TO BE DETERMINED IN FIELD PRIOR TO CONSTRUCTION

REFER TO DWG. 25-0581-R4 FOR ROADWORKS PAVING.

- LEGEND**
- PROP. ASPHALT REHABILITATION**
- FULL DEPTH MILL
 - SHAPE AND COMPACT EX. GRAVELS TO MINIMUM 95% MODIFIED PROCTOR DENSITY. MINIMUM GRAVEL THICKNESS OF 130mm REQUIRED
 - CONDUCT PROOF ROLL IN PRESENCE OF GEOTECHNICAL ENGINEER. PLACE ADDITIONAL GRAVEL AND COMPACT AS REQUIRED
 - PLACE MIN. 50mm UC#1 ASPHALT CEMENT PAVEMENT

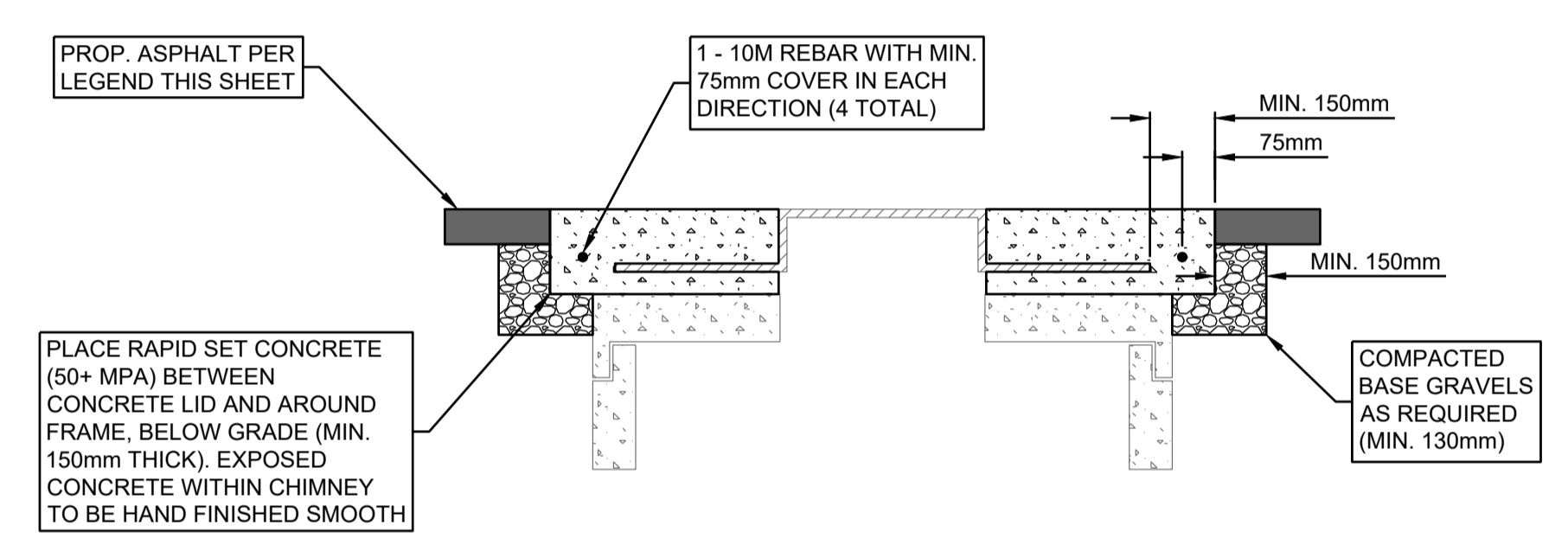

CATCHBASIN CONCRETE COLLAR
N.T.S.



EX. DOUBLE CB TO BE REMOVED AND REPLACED c/w 2 - TOP INLET CB'S AS PER COMOX DWG S20 c/w 2000 LEADS TIED INTO EX. STORM SEWER. CONTRACTOR TO PLACE CONCRETE COLLAR AROUND TOP OF EACH CB AS PER DETAIL THIS SHEET

REPAIR EX. ASPHALT SURROUNDING CB'S. EXTENTS TO BE CONFIRMED IN FIELD

ISSUED FOR CONSTRUCTION

PLOTTED: 2026-06-30 10:00 AM BY: COORDINATOR LAST SAVED BY: COORDINATOR
 PLOT: 2026-06-30 10:00 AM BY: COORDINATOR LAST SAVED BY: COORDINATOR

No.	DATE	REVISION	BY
A	2026-06-30	ISSUED FOR CONSTRUCTION	NP



R.F. BINNIE & ASSOCIATES LTD.
300 - 4940 Canada Way,
Burnaby, BC V5G 4K6
TEL 604 420 1721
BINNIE.com

CLIENT
TOWN OF COMOX
1809 Beaufort Avenue, Comox BC, V9M 1R9

DRAWING DESCRIPTION
HEATHER COURT & THISTLE COURT
SOUTH OF ROBB AVENUE
LOCAL PAVING & CB REPAIR

SURVEYED BY DB/SE
DRAWN BY KFB
DESIGNED BY NP
CHECKED BY GK

SCALES
1:250
0 1m 20m



DATE 2026-04-20
DRAWING No. 25-0581-R5
SHEET 8 **OF** 29 **REV.** A
DESTROY ALL PRINTS BEARING PREVIOUS No.

EGBC PERMIT No. 1001128