

CATCH BASIN TABLE

NUMBER	DESCRIPTION	LOCATION OF CATCHBASIN	RIM ELEV.	OUTLET INV.
CB05	CATCH BASIN WITH FLAT GRATE (COMOX S20)	STA. 1+145.000 o/s -6.700	53.79	52.99
CB06	CATCH BASIN WITH FLAT GRATE (COMOX S20)	STA. 1+175.000 o/s -6.700	52.42	51.62
CB07	CATCH BASIN WITH FLAT GRATE (COMOX S20)	STA. 1+220.000 o/s 4.300	50.80	50.00
CB08	CATCH BASIN WITH FLAT GRATE (COMOX S20)	STA. 1+223.034 o/s -6.700	50.69	49.89
CB09	CATCH BASIN WITH FLAT GRATE (COMOX S20)	STA. 1+275.034 o/s -6.700	49.74	48.94
CB10	CATCH BASIN WITH FLAT GRATE (COMOX S20)	STA. 1+293.153 o/s 4.300	49.41	48.61
CB11	CATCH BASIN WITH FLAT GRATE (COMOX S20)	STA. 1+293.598 o/s -5.447	49.62	48.82

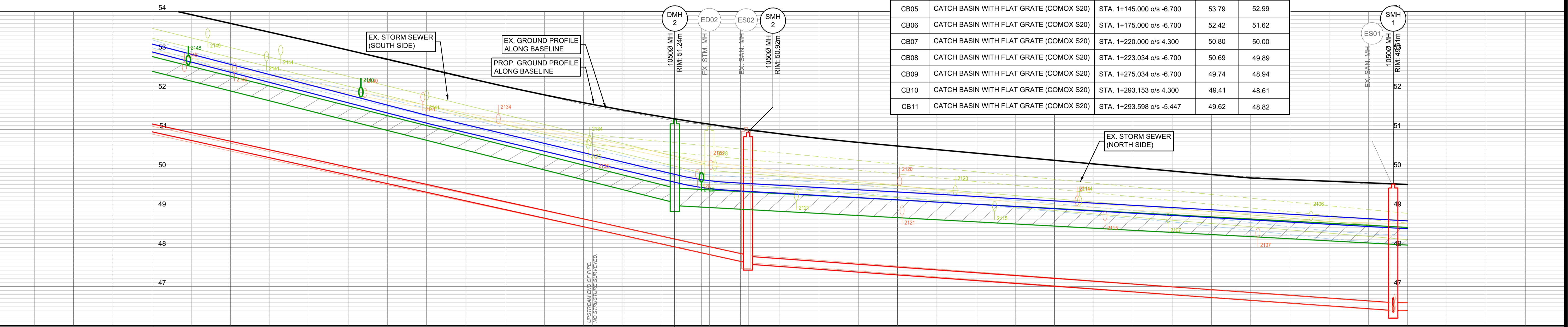

PROP. STORM SEWER	PROP. 100.00m-375Ø PVC DR35 STM. @ 5.03%	PROP. 100.00m-450Ø PVC DR35 STM. @ 1.07%
EX. STORM SEWER	EX. 250Ø STM. @ 4.89% (TO BE ABANDONED)	EX. 250Ø (NORTH SIDE) STM. @ 1.93% (TO BE ABANDONED) EX. 300Ø (SOUTH SIDE) STM. @ 1.64% (TO BE ABANDONED)
PROP. SAN SEWER	PROP. 83.00m-200Ø PVC DR35 SAN @ 4.40%	PROP. 82.00m-200Ø PVC DR35 SAN @ 1.44%
EX. SAN SEWER	EX. 200Ø SAN. @ 4.31% (TO BE ABANDONED)	EX. 200Ø SAN. @ 1.50% (TO BE ABANDONED)

STATION	1+140	1+160	1+180	1+196.114	1+200	1+206.618	1+211.024	1+215.964	1+220	1+240	1+260	1+280	1+297.920	1+300
---------	-------	-------	-------	-----------	-------	-----------	-----------	-----------	-------	-------	-------	-------	-----------	-------

ADDENDUM #2

This drawing must not be reproduced without the written permission of R.F. Binnie & Associates Ltd.
This drawing is not to be used for construction unless it is stamped "ISSUED FOR CONSTRUCTION" and signed by R.F. Binnie & Associates Ltd. It is the contractor's responsibility to ensure that he is in possession of the latest revision of this drawing.

No.	DATE	REVISION	BY
4	2026-05-25	ADDENDUM #2	NP
3	2026-05-08	ISSUED FOR TENDER	NP
2	2026-04-24	95% DESIGN SUBMISSION	NP
1	2026-03-27	50% SUBMISSION	NP

BINNIE
The people behind your infrastructure.

R.F. BINNIE & ASSOCIATES LTD.
300 - 4940 Canada Way,
Burnaby, BC V5G 4K6
TEL 604 420 1721
BINNIE.com

CLIENT
TOWN OF COMOX
1809 Beaufort Avenue, Comox BC, V9M 1R9

DRAWING DESCRIPTION
ROBB AVENUE UPGRADES
STA 1+140 - STA 1+300
SEWER

SURVEYED BY DB/SE
DRAWN BY KFB
DESIGNED BY NP
CHECKED BY GK

SCALES
H 1:250 10m
V 1:50 2m

EGBC PERMIT No. 1001128

DATE 2026-03-13
DRAWING No. 25-0581-S2
SHEET 11 **OF** 29 **REV.** 4
DESTROY ALL PRINTS BEARING PREVIOUS No.

PLOTTED: 2026-05-25 12:31:06 PM BY: J.L. LAST, LAST, Binnie & Associates Ltd. BROSIGER
 P: 604 420 1721 F: 604 420 1722 FAX: 604 420 1723 WWW.BINNIE.COM